

UNION ELBOW

INCH OD Tubes

T Tube A OD	C	D	E min.	F A/F	G	Hx TU-LOK Part No.	
1/16	17.8	11.0	8.6	1.3	11	8	14.0	1 SE
1/8	22.4	15.3	12.7	2.4	11	11	15.8	2 SE
1/4	26.9	17.8	15.3	4.8	14	14	19.6	4 SE
5/16	28.7	18.5	16.3	6.3	16	16	21.3	5 SE
3/8	30.5	19.3	16.8	7.1	17	17	23.2	6 SE
1/2	36.0	21.8	22.9	10.4	22	22	25.9	8 SE
5/8	38.1	21.8	24.4	12.7	24	25	27.9	10 SE
3/4	39.9	21.8	24.4	15.8	27	28.5	29.7	12 SE
7/8	44.7	21.8	25.9	18.2	35	32	34.6	14 SE
1	49.0	26.4	31.2	22.3	35	38	36.8	16 SE
1.1/4	66.6	38.9	41.2	27.6	46	50	44.5	20 SE
1.1/2	78.0	45.2	50.0	34.0	55	57	50.8	24 SE
2	107.2	62.7	67.6	46.0	70	76	69.9	32 SE

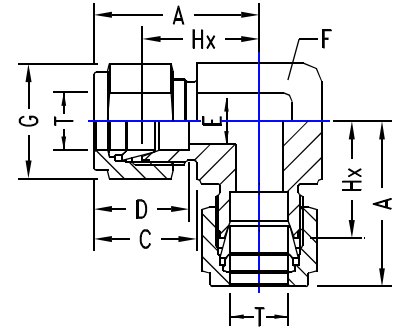

METRIC OD Tubes

T Tube A OD	C	D	E min.	F A/F	G	Hx TU-LOK.. Part No.	
3	22.3	15.3	12.9	2.4	11	11	15.7	SE-3
6	27.0	17.7	15.3	4.8	14	14	19.6	SE-6
8	28.8	18.6	16.2	6.3	16	16	21.3	SE-8
10	31.5	19.5	17.2	7.9	17	19	23.9	SE-10
12	36.0	22.0	22.8	9.5	22	22	25.9	SE-12
14	38.0	22.0	24.4	11.1	24	25	27.9	SE-14
15	38.0	22.0	24.4	11.9	24	25	27.9	SE-15
16	38.0	22.0	24.4	12.7	24	25	27.9	SE-16
18	39.8	22.0	24.4	15.1	27	30	29.7	SE-18
20	44.6	22.0	26.0	15.9	32	32	34.5	SE-20
22	44.6	22.0	26.0	18.3	32	32	34.5	SE-22
25	49.1	26.5	31.3	21.8	35	38	36.8	SE-25
28	64.0	36.6	36.6	21.8	41	46	43.5	SE-28
30	69.9	39.2	39.6	26.2	46	50	48.3	SE-30
32	72.3	41.6	42.0	28.6	46	50	49.3	SE-32
38	84.0	47.9	49.4	33.7	55	57	56.4	SE-38

BULKHEAD ELBOW

INCH OD Tubes

T Tube A OD	Ax	Ay	C	D	E min.	F A/F	G A/F	H	Hx	Hy	Panel Hole Drill Size	Max. Panel Thick- ness TU-LOK.. Part No.	
1/8	43.1	31.2	22.4	15.3	12.7	2.4	11	11	36.5	24.6	15.8	8.3	12.7	2 SEB
1/4	48.9	33.6	26.9	17.8	15.3	4.8	16	14	41.5	26.2	19.6	11.5	10.1	4 SEB
3/8	54.1	36.8	30.5	19.3	16.8	7.1	22	17	46.8	29.5	23.2	14.6	11.1	6 SEB
1/2	63.5	41.9	36.0	21.8	22.9	10.4	24	22	53.4	31.8	25.9	19.5	12.7	8 SEB
3/4	75.3	47.5	39.9	21.8	24.4	16.0	30	29	65.2	37.4	29.7	25.8	16.8	12 SEB
1	91.8	57.4	49.0	26.4	31.2	22.3	35	38	79.6	45.2	36.8	33.7	19.0	16 SEB

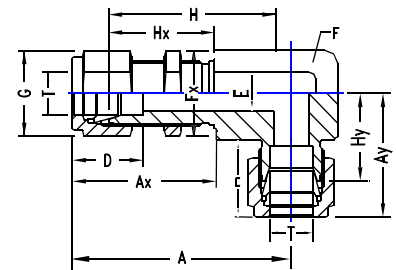

METRIC OD Tubes

T Tube A OD	Ax	Ay	C	D	E min.	F A/F	G A/F	H	Hx	Hy	Panel Hole Drill Size	Max. Panel Thick- ness TU-LOK.. Part No.	
3	43.0	31.2	22.3	15.3	12.9	2.4	14	11	36.4	24.6	15.7	8.3	12.7	SEB-3
6	49.3	33.6	27.0	17.7	15.3	4.8	16	14	41.9	26.2	19.6	11.5	10.2	SEB-6
8	52.6	36.1	28.8	18.6	16.2	6.3	17	16	45.1	28.6	21.3	13.1	11.2	SEB-8
10	56.2	37.0	31.5	19.5	17.2	7.9	22	19	48.6	29.4	23.9	16.3	11.2	SEB-10
12	63.0	41.9	36.0	22.0	22.8	9.5	24	22	52.9	31.8	25.9	19.5	12.7	SEB-12
16	66.5	42.6	38.0	22.0	24.4	12.7	27	25	56.4	32.5	27.9	22.8	12.7	SEB-16
22	85.1	53.0	44.6	22.0	26.0	18.3	35	32	75.0	42.9	34.5	29.0	19.0	SEB-20
25	91.8	57.4	49.1	26.4	31.2	22.3	35	38	79.6	45.2	36.8	33.7	19.0	SEB-25