

UNION CROSS

INCH OD Tubes

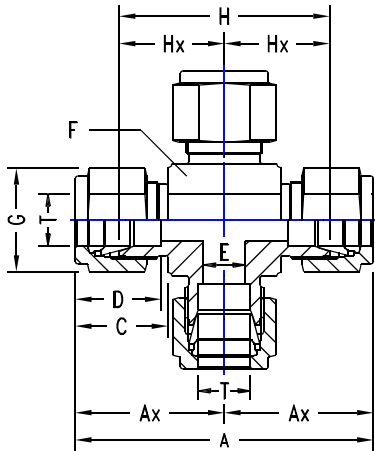

T Tube OD	A	Ax	C	D	E min.	F A/F	G A/F	H	Hx TU-LOK... Part No.
1/8	44.8	22.4	15.3	12.7	2.4	11	11	31.6	15.8	2 SK
1/4	53.8	26.9	17.8	15.3	4.8	14	14	39.2	19.6	4 SK
3/8	61.0	30.5	19.3	16.8	7.1	17	17	46.4	23.2	6 SK
1/2	72.0	36.0	21.8	22.9	10.4	22	22	51.8	25.9	8 SK
3/4	79.8	39.9	21.8	24.4	15.8	27	28.5	59.4	29.7	12 SK
1	98.0	49.0	26.4	31.2	22.3	35	38	73.6	36.8	16 SK

METRIC OD Tubes

T Tube OD min.	A	Ax	C	D	E	F A/F	G A/F	H	Hx	TU-LOK... Part No.
3	44.6	22.3	15.3	12.9	2.4	11	11	31.4	15.7	SK-3
6	54.0	27.0	17.7	15.3	4.8	14	14	39.2	19.6	SK-6
8	57.6	28.8	18.6	16.2	6.3	16	16	42.6	21.3	SK-8
10	63.0	31.5	19.5	17.2	7.9	17	19	47.8	23.9	SK-10
12	72.0	36.0	22.0	22.8	9.5	22	22	51.8	25.9	SK-12
16	76.0	38.0	22.0	24.4	12.7	24	25	55.8	27.9	SK-16
22	89.2	44.6	22.0	26.0	18.3	32	32	69.0	34.5	SK-22
25	98.2	49.1	26.5	31.3	21.8	35	38	73.6	36.8	SK-25

NOTE: Reducing Cross with variation in the tube sizes are available. The tube sizes are designated in the order given below.

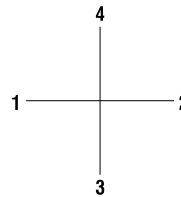

The tube sizes are indicated in the part number in the same order above.