

## MALE ADAPTER

### INCH OD Tubes x Male NPT Threads

T e NPT OD	P Male	A	B	E min.	F A/F	TU-LOK... Part No.
1/8	1/8	29.5	9.6	4.8	11	2 SAM-N
1/8	1/4	34.8	14.4	7.1	14	2-4 SAM-N
1/4	1/8	31.8	9.6	4.8	11	4-2 SAM-N
1/4	1/4	37.0	14.3	4.8	14	4 SAM-N
1/4	3/8	37.8	14.3	4.8	19	4-6 SAM-N
1/4	1/2	43.4	19.1	4.8	22	4-8 SAM-N
5/16	1/4	38.1	14.3	6.3	14	5-4 SAM-N
3/8	1/4	38.9	14.3	7.1	14	6-4 SAM-N
3/8	3/8	39.6	14.3	7.1	19	6 SAM-N
3/8	1/2	45.2	19.1	7.1	22	6-8 SAM-N
1/2	1/4	44.5	14.3	7.1	14	8-4 SAM-N
1/2	3/8	45.2	14.3	9.9	19	8-6 SAM-N
1/2	1/2	50.8	19.1	9.9	22	8 SAM-N
5/8	1/2	52.3	19.1	11.9	22	10-8 SAM-N
3/4	1/2	52.3	19.1	11.9	22	12-8 SAM-N
3/4	3/4	52.3	19.1	15.0	27	12 SAM-N
1	3/4	58.7	19.1	15.7	27	16 SAM-N
1	1	66.0	23.8	20.3	35	16-12 SAM-N
1.1/4	1.1/4	80.3	23.8	27.6	45	20 SAM-N
1.1/2	1.1/2	94.5	26.2	33.2	55	24 SAM-N

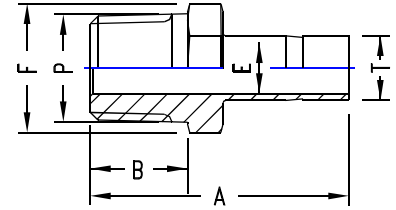

### INCH OD Tubes x Male ISO\* Tapered Pipe Threads

T Tube ISO OD	P Male	A	B	E min.	F A/F	TU-LOK Part No.
1/8	1/8	29.5	9.6	4.8	11	2 SAM-Rx
1/8	1/4	34.8	14.4	7.1	14	2-4 SAM-Rx
1/4	1/8	31.8	9.6	4.8	11	4-2 SAM-Rx
1/4	1/4	37.0	14.3	4.8	14	4 SAM-Rx
1/4	3/8	37.8	14.3	4.8	19	4-6 SAM-Rx
1/4	1/2	43.4	19.1	4.8	22	4-8 SAM-Rx
3/8	1/4	38.9	14.3	7.1	14	6-4 SAM-Rx
3/8	3/8	39.6	14.3	7.1	19	6 SAM-Rx
3/8	1/2	45.2	19.1	7.1	22	6-8 SAM-Rx
1/2	1/4	44.5	14.3	7.1	14	8-4 SAM-Rx
1/2	3/8	45.2	14.3	9.9	19	8-6 SAM-Rx
1/2	1/2	50.8	19.1	9.9	22	8 SAM-Rx
3/4	3/4	52.3	19.1	15.0	27	12 SAM-Rx
1	1	66.0	23.8	20.3	35	16-12 SAM-Rx
1.1/4	1.1/4	80.3	23.8	27.6	45	20 SAM-Rx
1.1/2	1.1/2	94.5	26.2	33.2	55	24 SAM-Rx

\* Reference Specifications : BS 21: ISO 7/1 : JIS B 0203 : DIN 2999 : IS 554

## MALE ADAPTER

### METRIC OD Tubes x Male NPT Threads

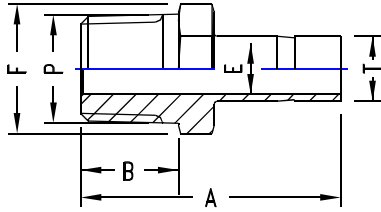

T Tube OD	P NPT Male	A	B	E min.	F A/F	TU-LOK Part No.
3	1/4	34.8	9.6	7.1	14	SAM 3-2N
6	1/8	32.8	14.3	4.6	14	SAM 6-2N
6	1/4	38.1	14.3	4.6	14	SAM 6-4N
8	1/4	39.1	14.3	6.2	14	SAM 8-4N
10	1/4	39.9	14.3	7.7	14	SAM 10-4N
10	3/8	40.6	14.3	7.7	19	SAM 10-6N
12	1/4	46.5	14.3	7.1	14	SAM 12-4N
12	3/8	46.5	14.3	9.1	19	SAM 12-6N
12	1/2	52.0	14.3	9.1	22	SAM 12-8N
25	3/4	62.0	19.1	15.7	27	SAM 25-12N
25	1	66.8	23.8	15.7	35	SAM 25-16N
30	1	79.2	23.8	22.2	41	SAM 30-16N
30	1.1/4	80.0	23.8	24.6	45	SAM 30-20N
32	1.1/4	81.0	23.8	27.4	46	SAM32-20N
38	1.1/2	92.2	26.2	33.3	55	SAM 38-24N

### METRIC OD Tubes x Male ISO\* Tapered Pipe Threads

T Tube OD	P ISO Male	A	B	E min.	F A/F	TU-LOK Part No.
3	1/4	34.8	9.6	7.1	14	SAM 3-2Rx
6	1/8	32.8	14.3	4.6	14	SAM 6-2Rx
6	1/4	38.1	14.3	4.6	14	SAM 6-4Rx
8	1/4	39.1	14.3	6.2	14	SAM 8-4Rx
10	1/4	39.9	14.3	7.7	14	SAM 10-4Rx
10	3/8	40.6	14.3	7.7	19	SAM 10-6Rx
12	1/4	46.5	14.3	7.1	14	SAM 12-4Rx
12	3/8	46.5	14.3	9.1	19	SAM 12-6Rx
12	1/2	52.0	14.3	9.1	22	SAM 12-8Rx
25	3/4	62.0	19.1	15.7	27	SAM 25-12Rx
25	1	66.8	23.8	15.7	35	SAM 25-16Rx
30	1	79.2	23.8	22.2	41	SAM 30-16Rx
30	1.1/4	80.0	23.8	24.6	45	SAM 30-20Rx
32	1.1/4	81.0	23.8	27.4	46	SAM32-20Rx
38	1.1/2	92.2	26.2	33.3	55	SAM 38-24Rx

\* Reference Specifications : BS 21: ISO 7/1 : JIS B 0203 : DIN 2999 : IS 554