

## REDUCING UNION

### INCH OD Tubes

T Tube NoOD	Tx Tube OD	A	C	Cx	D	Dx	E min.	F A/F	G A/F	Gx A/F	H	TU-LOK ..... Part No.
1/4	1/8	38.6	17.8	15.3	15.3	12.7	2.4	14	14	11	24.6	4-2 SCR
5/16	1/8	39.6	18.6	15.3	16.3	12.7	2.4	14	16	11	25.7	5-2 SCR
5/16	1/4	42.2	18.6	17.8	16.3	15.3	4.8	14	16	14	27.5	5-4 SCR
3/8	1/8	40.9	19.3	15.3	16.8	12.7	2.4	16	17	11	26.9	6-2 SCR
3/8	1/4	43.2	19.3	17.8	16.8	15.3	4.8	16	17	14	28.5	6-4 SCR
1/2	1/8	45.2	21.8	15.3	22.9	12.7	2.4	22	22	11	28.5	8-2 SCR
1/2	1/4	47.0	21.8	17.8	22.9	15.3	4.8	22	22	14	29.5	8-4 SCR
1/2	3/8	48.5	21.8	19.3	22.9	16.8	7.1	22	22	17	31.0	8-6 SCR
5/8	3/8	49.3	21.8	19.3	24.4	16.8	7.1	24	25	17	31.8	10-6 SCR
5/8	1/2	52.0	21.8	21.8	24.4	22.9	10.4	24	25	22	31.8	10-8 SCR
3/4	1/4	49.3	21.8	17.8	24.4	15.3	4.8	27	28.5	14	31.8	12-4 SCR
3/4	3/8	50.8	21.8	19.3	24.4	16.8	7.1	27	28.5	17	33.3	12-6 SCR
3/4	1/2	53.6	21.8	21.8	24.4	22.9	10.4	27	28.5	22	33.3	12-8 SCR
No. 1	1/2	60.5	26.5	21.8	31.2	22.9	10.4	35	38	22	38.1	16-8 SCR
1	3/4	60.5	26.5	21.8	31.2	24.4	15.8	35	38	28.5	38.1	16-12 SCR
1.1/4	1	92.2	38.9	26.4	41.2	31.2	22.3	45	50	38	48.0	20-16 SCR
1.1/2	1.1/4	60.5	26.5	21.8	31.2	24.4	15.8	55	57	50	53.6	24-20 SCR

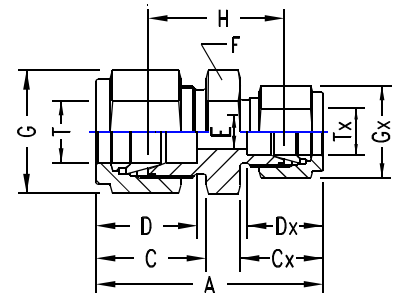

### METRIC OD Tubes

T Tube OD	Tx Tube OD	A	C	Cx	D	Dx	E min.	F A/F	G A/F	Gx A/F	H	TU-LOK.. ..... Part No.
6	3	38.6	17.7	15.3	15.3	12.9	2.4	14	14	11	24.6	SCR 6-3
8	6	42.3	18.6	17.7	16.2	15.3	4.8	14	16	14	27.4	SCR 8-6
10	6	44.5	19.5	17.7	17.2	15.3	4.8	17	19	14	29.5	SCR 10-6
10	8	45.1	19.5	18.6	17.2	16.2	6.3	17	19	16	30.0	SCR 10-8
12	6	47.0	22.0	17.7	22.8	15.3	4.8	22	22	14	29.5	SCR 12-6
12	8	47.8	22.0	18.6	22.8	16.2	6.4	22	22	16	30.2	SCR 12-8
No. 10	10	48.7	22.0	19.5	22.8	17.2	7.9	22	22	19	31.0	SCR 12-10
16	10	49.5	22.0	19.5	24.4	17.2	7.9	24	25	19	31.8	SCR 16-10
16	12	52.0	22.0	22.0	24.4	22.8	9.5	24	25	22	31.8	SCR 16-12
22	18	55.0	22.0	22.0	26.0	24.4	15.1	30	32	30	34.8	SCR 22-18
22	20	55.0	22.0	22.0	26.0	26.6	15.9	30	32	32	34.8	SCR 22-20
25	12	65.0	26.5	22.0	31.3	22.8	9.5	35	38	22	40.4	SCR 25-12
25	20	65.0	26.5	22.0	31.3	26.0	15.9	35	38	32	40.4	SCR 25-20
30	20	75.4	39.2	22.0	39.6	26.0	15.9	45	50	32	43.7	SCR 30-20
30	25	80.1	39.2	26.5	39.6	31.3	21.8	45	50	38	46.2	SCR 30-25
32	20	77.8	41.6	22.0	42.0	26.0	15.9	45	50	32	44.7	SCR 32-20
32	25	82.3	41.6	26.5	42.0	31.3	21.8	45	50	38	47.0	SCR 32-25
38	20	92.0	47.9	26.5	49.4	31.3	21.8	55	57	38	52.1	SCR 38-20
38	25	104.6	47.9	39.2	49.4	39.6	26.2	55	57	50	55.4	SCR 38-25

No.

**NOTE:** The combinations shown above are representative of various possibilities. Other combinations not shown are also available. Please consult us.