

MALE RUN TEE

INCH OD Tubes X Male NPT Threads

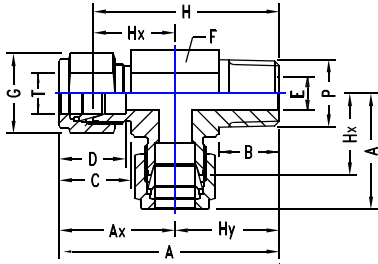

T Tube OD	P NPT Male	A	Ax	B	C	D	E min.	F	G A/F	H A/F	Hx	Hy	TU-LOK Part No.
1/8	1/8	41.4	23.6	9.6	15.3	12.7	2.4	11	11	34.8	17.0	17.8	2 STRM-N
1/8	1/4	48.0	24.6	14.3	15.3	12.7	2.4	14	11	41.4	18.0	23.4	2-4 STRM-N
1/4	1/8	45.7	26.9	9.6	17.8	15.3	4.8	14	14	38.4	19.6	18.8	4-2 STRM-N
1/4	1/4	50.3	26.9	14.3	17.8	15.3	4.8	14	14	43	19.6	23.4	4 STRM-N
1/4	3/8	55.9	29.7	14.3	17.8	15.3	4.8	19	14	48.8	22.4	26.2	4-6 STRM-N
1/4	1/2	64.8	31.8	19.1	17.8	15.3	4.8	22	14	57.4	24.4	33.0	4-8 STRM-N
3/8	1/4	55.9	30.5	14.3	19.3	16.8	7.1	17	17	48.5	23.1	25.4	6-4 STRM-N
3/8	3/8	57.4	31.2	14.3	19.3	16.8	7.1	19	17	50.1	23.9	26.2	6 STRM-N
3/8	1/2	66.0	33.0	19.1	19.3	16.8	7.1	22	17	58.9	25.9	33.0	6-8 STRM-N
1/2	1/4	64.2	36.0	14.3	21.8	22.9	4.8	22	22	54.1	25.9	28.2	8-4 STRM-N
1/2	3/8	64.2	36.0	14.3	21.8	22.9	9.6	22	22	54.1	25.9	28.2	8-6 STRM-N
1/2	1/2	69.0	36.0	19.1	21.8	22.9	10.4	22	22	58.9	25.9	33.0	8 STRM-N
5/8	1/2	73.1	38.1	19.1	21.8	24.4	11.9	22	25	62.9	27.9	35.0	10-8 STRM-N
3/4	1/2	76.7	39.9	19.1	21.8	24.4	11.9	27	29	66.5	29.7	36.8	12-8 STRM-N
3/4	3/4	76.7	39.9	19.1	21.8	24.4	15.8	27	29	66.5	29.7	36.8	12 STRM-N
1	3/4	90.6	49.0	19.1	26.4	31.2	15.8	35	38	78.4	36.8	41.6	16-12 STRM N
1	1	95.5	49.0	23.8	26.4	31.2	22.3	35	38	83.3	36.8	46.5	16 STRM-N
1.1/4	1.1/4	114.1	66.5	23.8	38.8	41.1	27.6	46	50	92.1	44.5	47.6	20 STRM-N
1.1/2	1.1/2	138.4	78.0	26.2	45.2	50.0	34.0	55	57	111.2	50.8	60.4	24 STRM-N

METRIC OD Tubes X Male NPT Threads

T Tube OD	P NPT Male	A	Ax	B	C	D	E min.	F	G A/F	H A/F	Hx	Hy	TU-LOK Part No.
3	1/8	41.4	23.6	9.6	15.3	12.9	2.4	11	11	34.8	17.0	17.8	STRM 3-2N
3	1/4	48.0	24.6	14.3	15.3	12.9	2.4	14	11	41.4	18.0	23.4	STRM 3-4N
6	1/8	45.8	27.0	9.6	17.7	15.3	4.8	14	14	38.9	19.6	18.8	STRM 6-2N
6	1/4	50.4	27.0	14.3	17.7	15.3	4.8	14	14	43.0	19.6	23.4	STRM 6-4N
6	3/8	56.0	29.8	14.3	17.7	15.3	4.8	19	14	48.6	22.4	26.2	STRM 6-N
8	1/4	53.2	28.8	14.3	18.6	16.2	6.3	14	16	45.7	21.3	24.4	STRM 8-4N
8	3/8	56.8	30.6	14.3	18.6	16.2	6.3	19	16	49.3	23.1	26.2	STRM 8-6N
8	1/2	65.6	32.6	19.1	18.6	16.2	6.3	22	16	58.1	25.1	33.0	STRM 8-N
10	1/4	57.7	31.5	14.3	19.5	17.2	7.1	17	19	50.1	23.9	26.2	STRM 10-4N
10	3/8	57.7	31.5	14.3	19.5	17.2	7.9	19	19	50.1	23.9	26.2	STRM 10-6N
10	1/2	66.5	33.5	19.1	19.5	17.2	7.9	22	19	58.9	25.9	33.0	STRM 10-8N
12	1/4	62.2	36.0	14.3	22.0	22.8	7.1	22	22	52.1	25.9	26.2	STRM 12-4N
12	3/8	62.2	36.0	14.3	22.0	22.8	9.5	22	22	52.1	25.9	28.2	STRM 12-6N
12	1/2	69.0	36.0	19.1	22.0	22.8	9.5	22	22	58.9	25.9	33.0	STRM 12-8N
16	1/2	73.1	38.0	19.1	22.0	24	11.9	24	25	64.0	27.9	35.1	STRM 16-8N
25	3/4	90.8	49.1	19.1	26.5	31.3	15.8	35	38	78.5	36.8	41.7	STRM 25-12N
25	1	95.6	49.1	23.8	26.5	31.3	21.8	35	38	83.3	36.8	46.5	STRM 25-16N
30	1.1/4	120.0	66.9	23.8	39.2	39.6	26.2	45	50	101.4	48.3	53.1	STRM 30-20N
32	1.1/4	125.4	72.3	23.8	41.6	42.0	27.6	45	50	102.4	49.3	53.1	STRM 32-20N
38	1.1/2	144.4	84.0	26.2	47.9	50.0	33.7	55	57	116.8	56.4	60.4	STRM 38-24N

NOTE: The combination of tube OD and male threads are indicative of popular sizes. Other combinations, not shown, are available. Please Consult us.